

C1CSB LP/NG INSTALLATION GUIDE

STEP 1

- Remove the right side shelf from the cart
- The side shelf is supported by 4 screws - accessible from the bottom side

STEP 2

- Install 4 new bolts as well as the grommet provided (see picture 1) but do not tighten the bolts yet as the new side burner will rest on them in STEP 4



(picture 1)

STEP 3

- Remove the C1CSB control knobs
- Remove the front panel by removing the 2 screws on the top and 2 screws at the bottom (see pictures 2 & 3)



(picture 2)



(picture 3)

STEP 4

- Install the side burner body on the cart by hooking and latching the burner onto the cart's screws installed in STEP 2 (see picture 4)



(picture 4)

STEP 5

- Tighten the bolts that hold the C1CSB onto the cart
 - Screws are accessible on the back at locations A and B (see picture 5) and locations C and D on the front (see picture 6)

(picture 5)

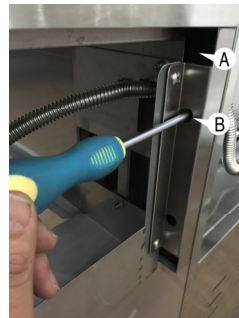
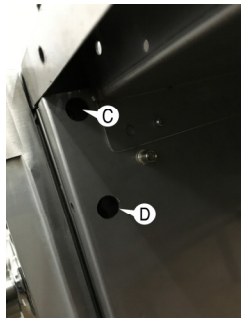

(picture 6)

STEP 6

- Reinstall the C1CSB control panel by reattaching the 2 upper screws and 2 lower bolts shown on step 3

STEP 7

- Install the new piping assembly (shown in picture 7) for the C1CSB and grill consisting of:
 - (1) 1/2" nipple x 3/8" nipple
 - (2) 1/2" tee
 - (3) 1/2" nipple x 3/8" nipple
 - (4) 1/2" nipple x 3/8" nipple

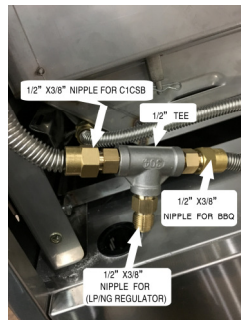

(picture 7)

FINISHING THE INSTALL:

- Pressure test all fittings with soapy water to ensure that no LP or NG gas leaks are present
- Finish by closing off and re-installing all panels on the back side of the C1CSB and the grill unit
- Your C1CSB is ready for use

****** Note: This is just an installation guide. For any further details regarding the proper hook-up of a gas supply, please refer to your owners manual for the grill and side burner itself***